



9C

Instrument Panel Removal and Installation

Removal

- 1) Disable air bag system. 
- 2) Remove floor console front panel. 
- 3) Remove front pillar trim. 
- 4) Remove dash side trim and side sill front scuff. 
- 5) Remove driver side instrument panel undercover (2), and then disconnect connector (1) while supporting it.

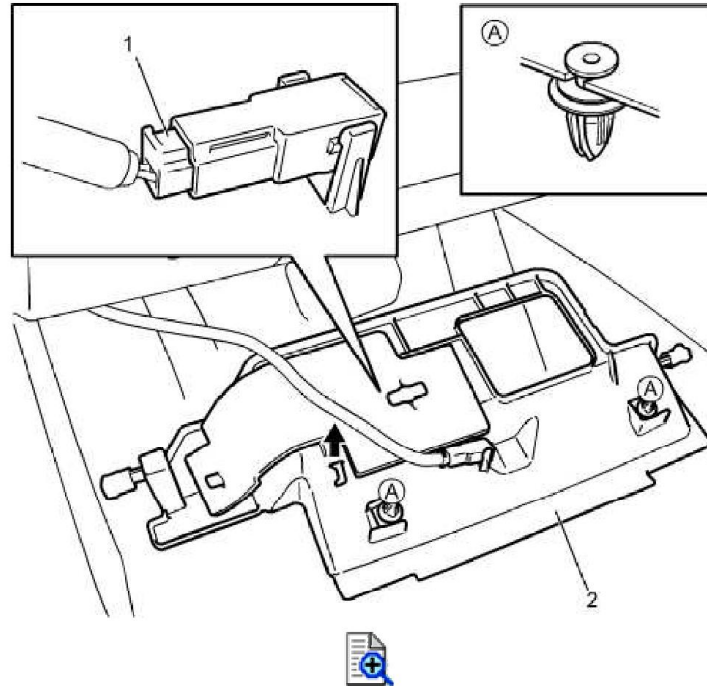

- 6) Remove screws (1) and remove steering column hole cover (2).

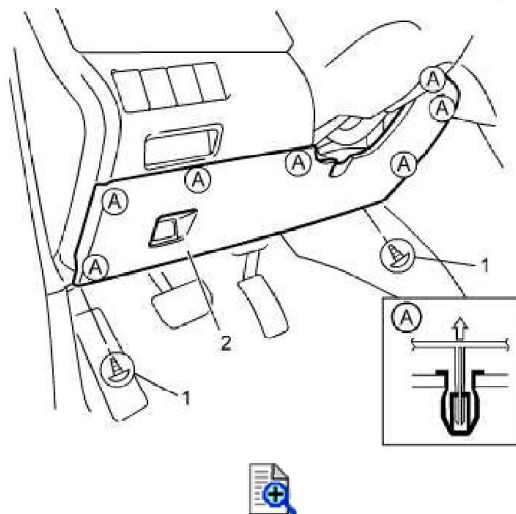

- 7) Remove steering column assembly. 
- 8) Remove screws (1) and remove glove box (2).

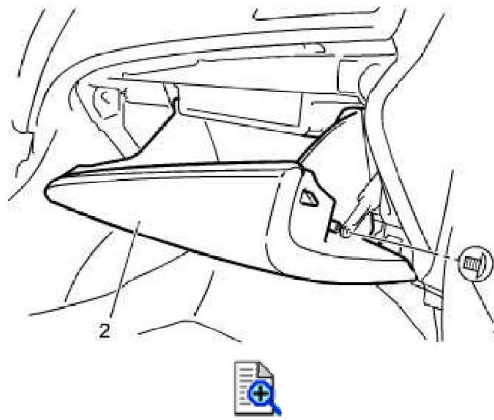

- 9)** Remove screws (1) to detach instrument panel undercover (3), and then disconnect floor light connector while supporting it.

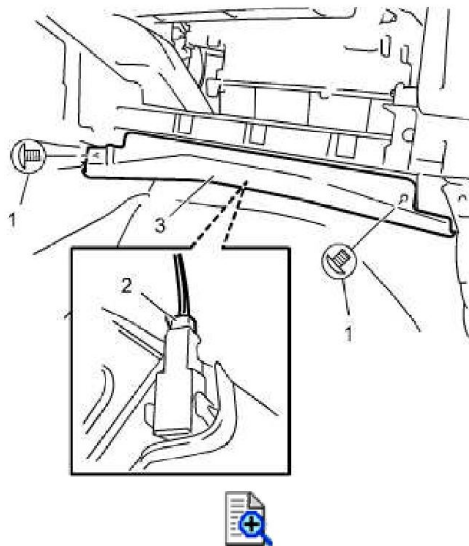

- 10)** Remove foot duct. 

- 11)** Remove steering support member lower bracket bolts (1) and remove steering support member lower bracket (2).

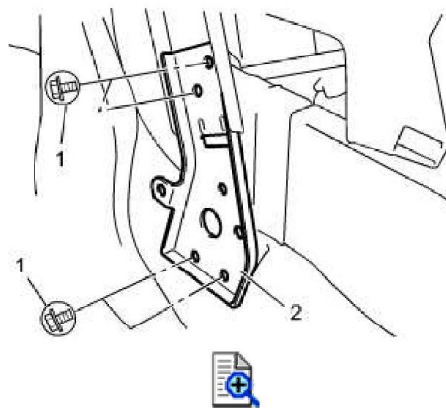

- 12)** Disconnect / remove the following parts as shown in figure: connectors (1) to (18), ground connections (19) and inside air temperature sensor aspirator duct (20).

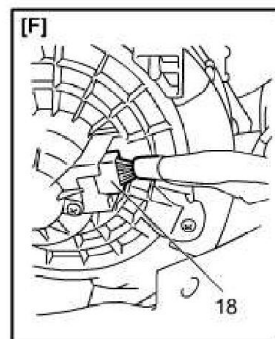
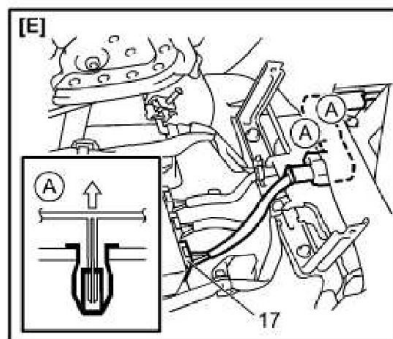
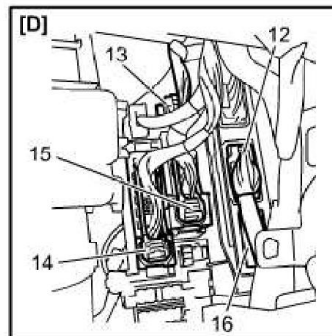
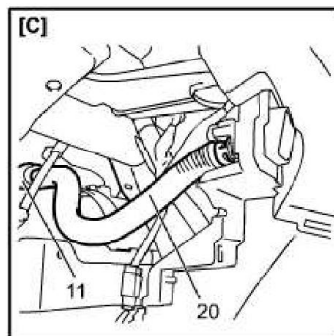
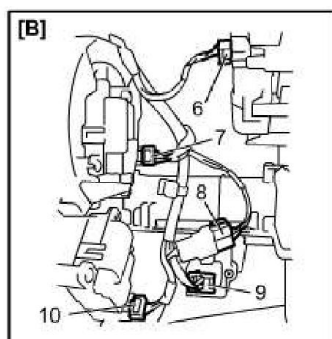
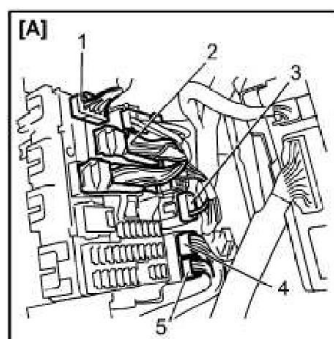
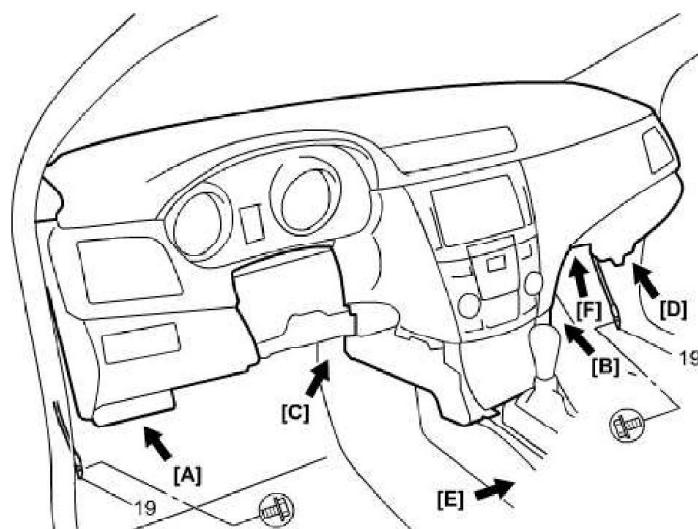

13) Remove steering support member bolts (1) and (2).

- 14)** Check that there is no harness or ground wire connected between instrument panel and vehicle while slightly raising and supporting instrument panel (3).
- 15)** Remove instrument panel, steering support member and instrument panel harness as assembly.

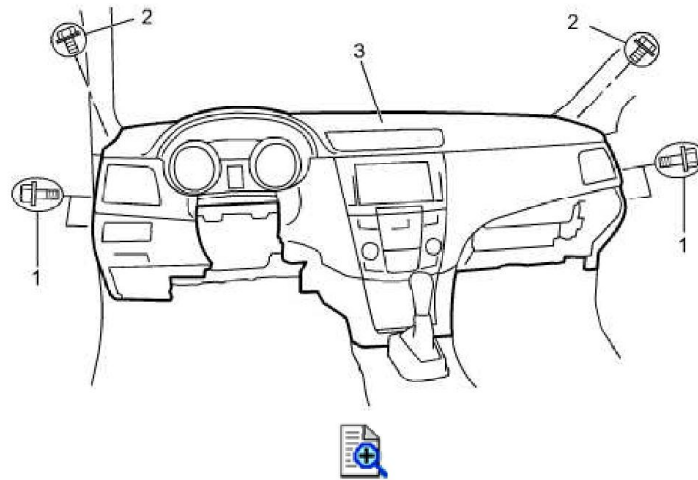

Installation

Reverse removal procedure noting the following points.

- Do not let cables or wire harnesses be pinched when installing parts.
- Enable air bag system. 
- Tighten steering support member side bolts in numerical order ("1" – "2") to specified torque.

Tightening torque

Steering support member bolt (a): 23 N·m (2.3 kg-m, 17.0 lbf-ft)

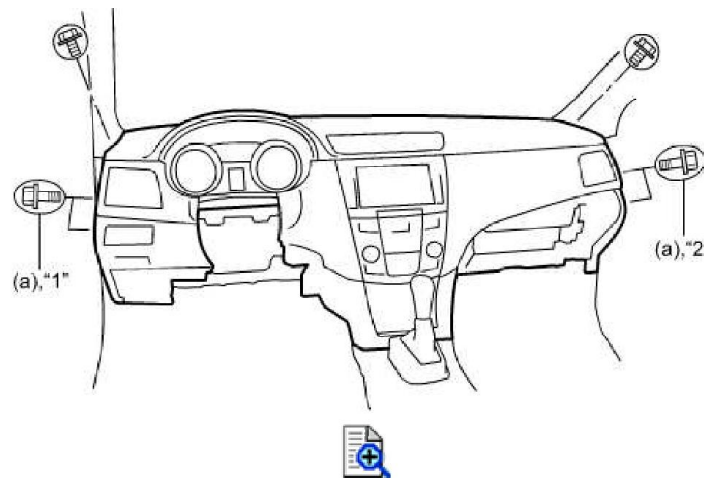

- Conduct every initialization after all works are completed.

9C

Instrument Panel Disassembly and Reassembly

Reference: Instrument Panel Removal and Installation

Disassembly

- 1) Remove the following parts as shown in figure.
- Instrument panel side cover (1)
 - Service manual case (2)
 - Passenger side instrument panel garnish (3)

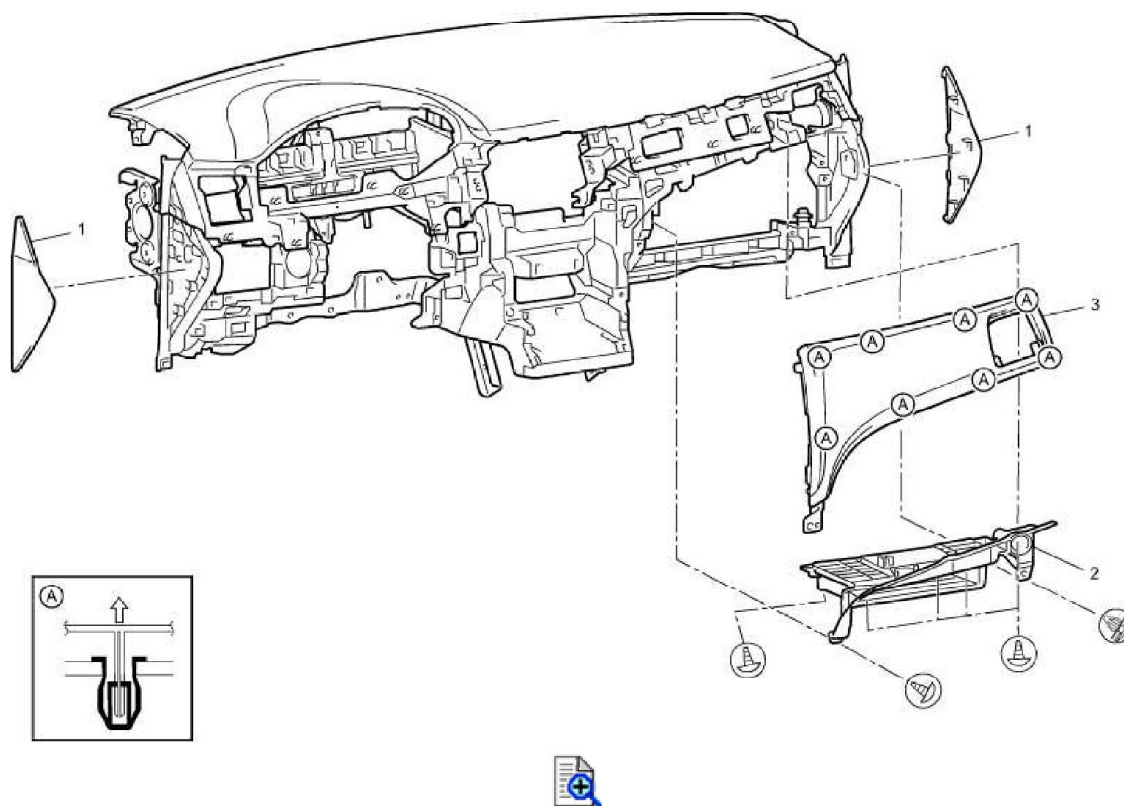

- 2) Remove screws and remove ventilator ducts (1).

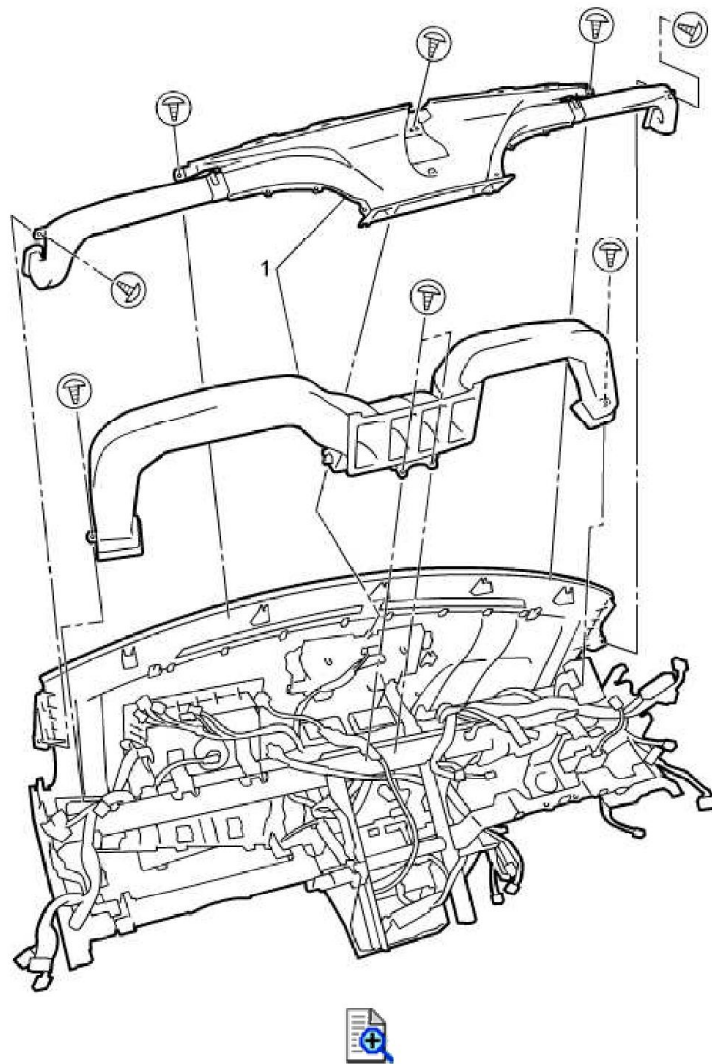

- 3)** Remove passenger air bag (inflator) module. 
- 4)** Remove instrument panel speaker cover (1).
- 5)** Disconnect instrument panel speaker connector.
- 6)** Remove screws and remove instrument panel speaker base (2).
- 7)** Remove screws and remove instrument panel main upper panel (3).